



Jerald Saunders - Landscape Architect  
MO License # LA-007

Consultants:

| ID   | Tree Name    | DBH | Condition Rating | Comment         | Preserved | To Be Removed |
|------|--------------|-----|------------------|-----------------|-----------|---------------|
| 2965 | Elm          | 12  | 2                |                 | x         |               |
| 2966 | Black Cherry | 7   | 1                | MoDOT ROW       |           | x             |
| 2968 | Red Cedar    | 7   | 2                | MoDOT ROW       |           | x             |
| 2969 | Red Cedar    | 9   | 2                |                 | x         |               |
| 2970 | Red Cedar    | 10  | 2                |                 | x         |               |
| 2971 | Honeylocust  | 7   | 2                |                 | x         |               |
| 2972 | Red Cedar    | 7   | 2                | MoDOT ROW       |           | x             |
| 2975 | Red Cedar    | 8   | 2                |                 |           | x             |
| 2976 | Red Cedar    | 8   | 2                |                 |           | x             |
| 2977 | Red Cedar    | 8   | 2                |                 |           | x             |
| 2979 | Hackberry    | 21  | 1                | in the washout  |           | x             |
| 2980 | Red Cedar    | 12  | 2                |                 |           | x             |
| 2981 | Oak          | 12  | 2                | along ROW fence | x         |               |
| 2982 | Elm          | 13  | 2                | along ROW fence | x         |               |
| 2983 | Oak          | 23  | 3                |                 | x         |               |
| 2984 | Ailanthus    | 20  | 2                |                 |           | x             |
| 2985 | Ailanthus    | 10  | 2                |                 |           | x             |
| 2986 | Boxelder     | 10  | 2                |                 |           | x             |
| 2987 | Ailanthus    | 10  | 2                |                 |           | x             |
| 2988 | Ailanthus    | 10  | 2                |                 |           | x             |
| 2989 | Black Cherry | 8   | 2                |                 |           | x             |
| 2990 | Ailanthus    | 10  | 2                |                 |           | x             |
| 2991 | Ailanthus    | 10  | 2                |                 |           | x             |
| 2992 | Boxelder     | 10  | 1                |                 |           | x             |
| 2993 | Ailanthus    | 8   | 2                |                 |           | x             |
| 2994 | Ailanthus    | 8   | 1                |                 |           | x             |
| 2995 | Black Walnut | 10  | 2                |                 |           | x             |
| 2996 | Boxelder     | 8   | 2                |                 |           | x             |
| 2997 | Ailanthus    | 8   | 2                |                 |           | x             |
| 2998 | Ailanthus    | 20  | 2                |                 |           | x             |
| 2999 | Ailanthus    | 18  | 2                |                 |           | x             |
| 3000 | Elm          | 20  | 1                |                 |           | x             |
| 3001 | Black Walnut | 10  | 2                |                 | x         |               |
| 3002 | Cottonwood   | 22  | 2                |                 | x         |               |
| 3003 | Black Walnut | 13  | 2                |                 |           | x             |
| 3004 | Elm          | 8   | 2                |                 |           | x             |
| 3005 | Elm          | 10  | 0                |                 |           | x             |

**Tree Condition Rating:**

|           |   |
|-----------|---|
| Excellent | 4 |
| Good      | 3 |
| Fair      | 2 |
| Poor      | 1 |
| Dead      | 0 |

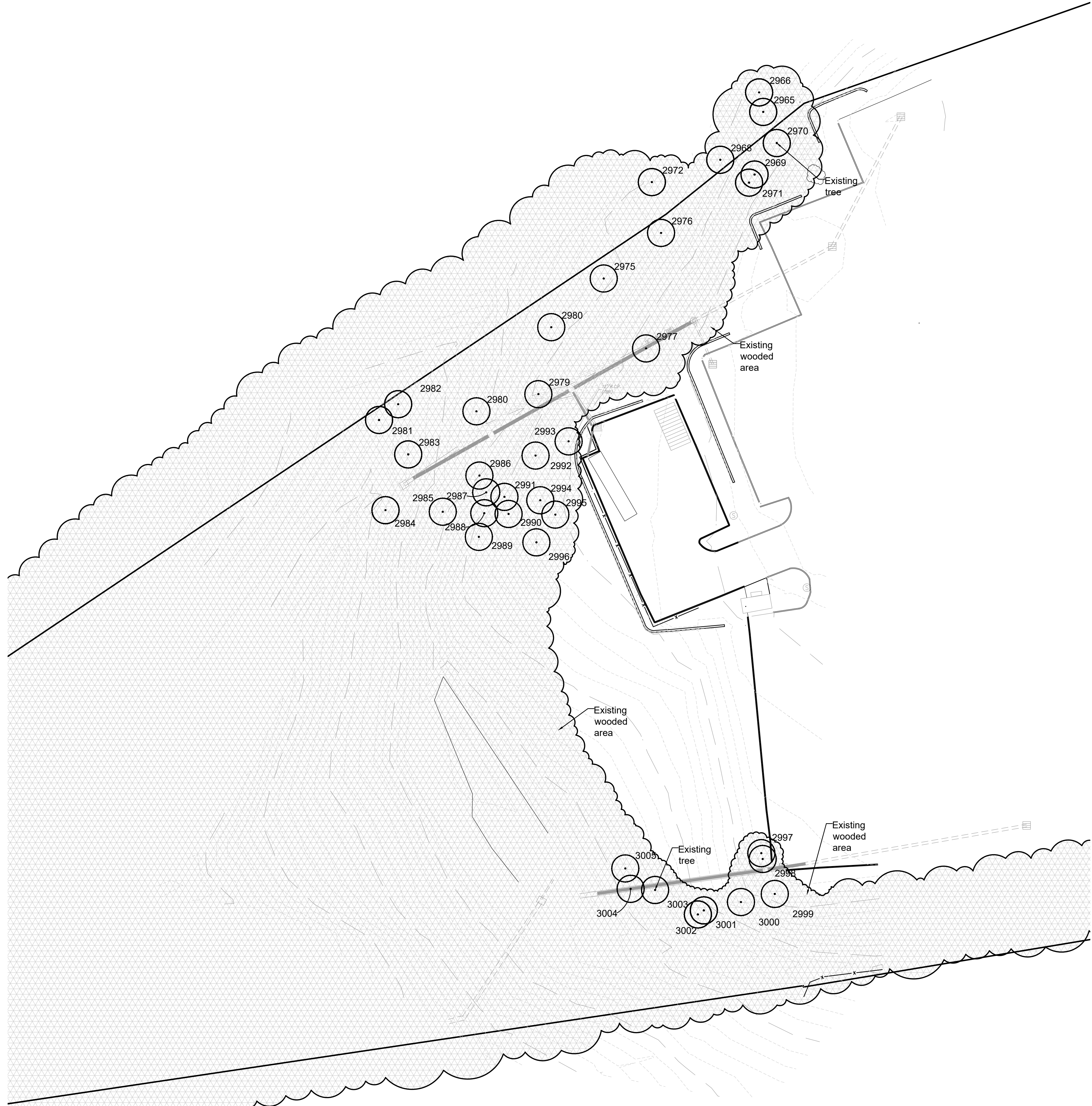

**Tree Stand Delineation Narrative**

This project area is surrounded by 4 acres of heavily forested mature oak-hickory woodland that appears to have been relatively undisturbed for many generations due to the steep slopes and drainage patterns. This work area was graded with the original development and has become overgrown with first succession vegetation consisting of primarily invasive species (Tree of Heaven, Bradford Pear) and Eastern Red Cedar.

This project requires the removal and disposal of 20,187 s.f. of tree canopy of little long term value. The Tree Stand Delineation map was completed by field inspection. There are no Landmark trees found in the project area.

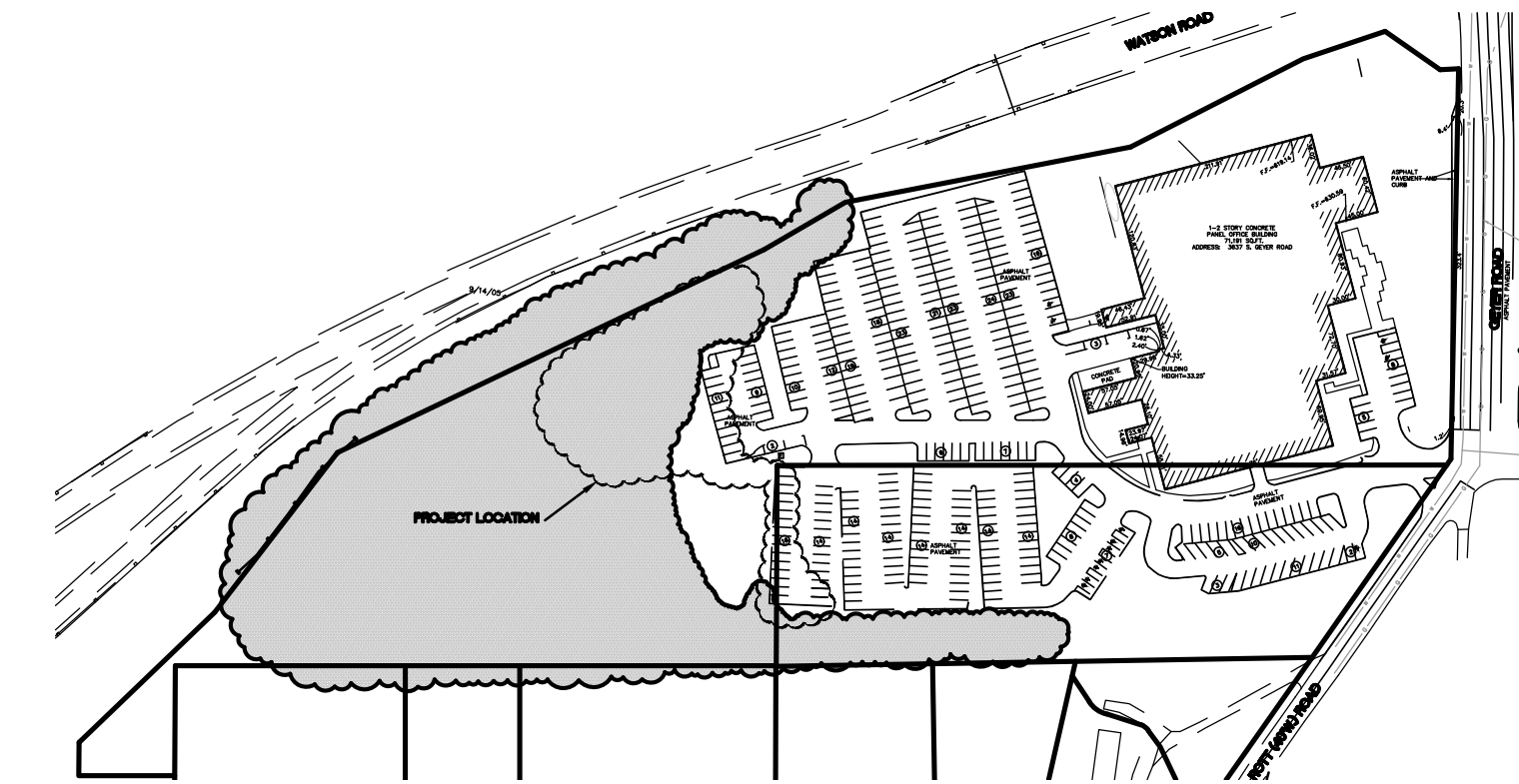

Partial Tree Stand Delineation  
SCALE 1"=30'

Key Plan  
SCALE 1"=200'

Revisions:

| Date | Description | No. |
|------|-------------|-----|
|      |             |     |
|      |             |     |
|      |             |     |
|      |             |     |
|      |             |     |
|      |             |     |
|      |             |     |
|      |             |     |
|      |             |     |
|      |             |     |

Drawn: KP  
Checked: RS

**LOOMIS ASSOCIATES**  
landscape architects + planners  
750 spirit of park drive, chesterfield, missouri 63005  
t. 636-519-6668 www.loomis-associates.com

Loomis Associates Inc.  
Missouri State Certificate of Authority #: LAC#0000191

|              |                        |
|--------------|------------------------|
| Sheet Title: | Tree Stand Delineation |
| Sheet No.:   | TSD                    |
| Date:        | 8/19/21                |
| Job #:       | 1030.002               |

**Mercy Health**  
12605 Rott Road  
Sunset Hills, Missouri 63127