

BP1318713247



JANICE M. HAMMONDS, RECORDER OF DEEDS
ST. LOUIS COUNTY MISSOURI
41 SOUTH CENTRAL, CLAYTON, MO 63105

TYPE OF INSTRUMENT: DEDI
GRANTOR: VONN DER AHE YVONNE ATTY IN FACT ETAL
TO: CITY OF SUNSET HILLS
GRANTEE:

PROPERTY DESCRIPTION: SEC 23 T 41 R 5

Form with three boxes: Lien Number, Notation X, Locator

NOTE: I, the undersigned Recorder of Deeds, do hereby certify that the information shown on this Certification Sheet as to the TYPE OF INSTRUMENT, the NAMES of the GRANTOR and GRANTEE as well as the DESCRIPTION of the REAL PROPERTY affected is furnished merely as a convenience only...

RECORDER OF DEEDS DOCUMENT CERTIFICATION

STATE OF MISSOURI)
Document Number 908
SS.
COUNTY OF ST. LOUIS)

I, the undersigned Recorder of Deeds for said County and State, do hereby certify that the following and annexed instrument of writing, which consists of 3 pages (this page inclusive), was filed for record in my office on the 31 day of July 2001 at 11:08 AM and is truly recorded in the book and at the page shown at the top and/or bottom of this page.

In witness whereof I have hereunto set my hand and official seal the day, month and year aforesaid.

Signature of Glenn Reber, Deputy Recorder



Signature of Janice M. Hammonds, Recorder of Deeds, St. Louis County, Missouri

- N.P.
N.P.C.
N.N.C.
N.N.I.

RECORDING FEE \$26.00
(Paid at the time of Recording)

Mail to:

Empty box for mail destination

Destination code: 3 P Do Not Remove This Page

B-13187 P-0247/0249

(2)
Notation

RIGHT OF WAY DEDICATION

MAYBELLE E. VON DER AHE being the owner(s) of a tract of land described in a deed recorded in Deed Book 12460 Page 1670 of the St. Louis County Records and being situated in the Northwest 1/4 of Section 23, Township 44 North, Range 5 East, City of Sunset Hills, St. Louis County, Missouri, do hereby dedicate to the City of Sunset Hills the area shown as hachured  on the attached Plat, hereby made a part of this instrument.

Said Owner(s) for and in consideration of the sum of One Dollar and No/100 (\$1.00) and other valuable considerations paid by the City of Sunset Hills, the receipt of which is hereby acknowledged, do, by these presents, grant to the City of Sunset Hills the area as aforementioned for road purposes and public use forever.

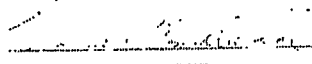

YVONNE VON DER AHE, Attorney-in-fact and
Trustee for Maybelle E. Von Der Ahe

COUNTY OF ST. LOUIS)
)SS.
STATE OF MISSOURI)

On this 11 day of April, 2000, before me personally appeared Yvonne Von Der Ahe to me known to be the person(s) described in and who executed the foregoing instrument, and acknowledged that he/she/they executed the same as his/her/their free act and deed. ~~(S) ATTORNEY-IN-FACT AND TRUSTEE FOR MAYBELLE E. VON DER AHE~~

IN TESTIMONY WHEREOF, I have hereunto set my hand and affixed my official seal in the County and State aforesaid, the day and year first above written.



Notary Public

My term expires: _____

KENDRA HAZER
Notary Public - Notary Seal
STATE OF MISSOURI
St. Charles County
My Commission Expires: Aug. 26, 2001



GRAPHIC SCALE



(IN FEET)
1 inch = 100 ft.

MERAMEC RIVER

N/F
THE MAYBELLE E. VON DER AHE
REVOCABLE LIVING TRUST
OF FEBRUARY 21, 1985
12460/1870

NEW ROW = 13,591 SQ. FT.

1032.2

N89°08'05"W

1032.9

S89°08'05"E

PROPOSED 25' ROW DEDICATION

N03°34'15"E
84.21'

R=1870.00'
L=157.66'

R=150.00'
L=67.11'

25.03'

S03°34'15"W
84.21'

R=1845.00'
L=155.55'

N08°24'05"E 248.20'

S08°24'05"W
284.73'

R=30.04'
L=29.47'

S25°23'50"E
5.03'

EXISTING CENTERLINE OF MAPLE LANE
PER ROAD ESMT (D.B. 6520 PG. 1350)

EXHIBIT "A"

INITIAL: ;

RIGHT-OF-WAY DEDICATION PLAT

A TRACT OF LAND BEING PART OF A LARGER TRACT OF LAND DESCRIBED IN A DEED TO THE MAYBELLE E. VON DER AHE REVOCABLE LIVING TRUST RECORDED IN DEED BOOK 12460 PAGE 1870 OF THE ST. LOUIS COUNTY RECORDS AND BEING SITUATED IN THE NORTHWEST 1/4 OF SECTION 23, TOWNSHIP 44

Description: St Louis, MO Document - Book, Page 13187.247 Page: 3 of 3
Order: 1028586 Comment:



**JANICE M. HAMMONDS, RECORDER OF DEEDS
ST. LOUIS COUNTY MISSOURI
41 SOUTH CENTRAL, CLAYTON, MO 63105**

TYPE OF INSTRUMENT: **DEDI** GRANTOR: **VON DER AHE TRUCK AND TRAILER SERV IN** TO: **CITY OF SUNSET HILLS** GRANTEE: **CITY OF SUNSET HILLS**

PROPERTY DESCRIPTION: **SEC 23 T 44 R 5**

Lien Number	Notation X	Locator
-------------	----------------------	---------

NOTE: I, the undersigned Recorder of Deeds, do hereby certify that the information shown on this Certification Sheet as to the TYPE OF INSTRUMENT, the NAMES of the GRANTOR and GRANTEE as well as the DESCRIPTION of the REAL PROPERTY affected is furnished merely as a convenience only, and in the case of any discrepancy of such information between this Certification Sheet and the attached Document, the ATTACHED DOCUMENT governs. The Recorder's official Grantor/Grantee indices are created from the information contained in the actual Document attached hereto. Only the DOCUMENT NUMBER, the DATE and TIME of filing for record, and the BOOK and PAGE of the recorded Document is taken from this CERTIFICATION SHEET.

RECORDER OF DEEDS DOCUMENT CERTIFICATION

STATE OF MISSOURI)

Document Number

SS.

909

COUNTY OF ST. LOUIS)

I, the undersigned Recorder of Deeds for said County and State, do hereby certify that the following and annexed instrument of writing, which consists of 3 pages, (this page inclusive), was filed for record in my office on the 31 day of July 2001 at 11:08 AM and is truly recorded in the book and at the page shown at the top and/or bottom of this page.

In witness whereof I have hereunto set my hand and official seal the day, month and year aforesaid.

Jolann Reber

Deputy Recorder

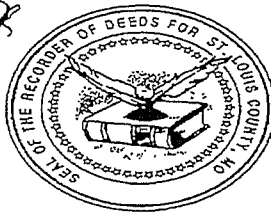

Janice M. Hammonds

Recorder of Deeds
St. Louis County, Missouri

N.P.

N.P.C.

N.N.C.

N.N.I.

RECORDING FEE **\$26.00**
(Paid at the time of Recording)

Mail to:

Destination code: 3 **P** **Do Not Remove This Page**

B-13187 F-0250/0252



GRAPHIC SCALE

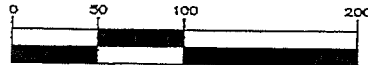

(IN FEET)
1 inch = 100 ft.

MERAMEC RIVER

N/F
VON DER AHE
TRUCK AND TRAILER
SERVICE, INC.
6742/1582

1285'±

1032'±

N88°26'59"W

S89°08'05"E

NEW ROW = 12,478 SQ. FT.

PROPOSED 25' ROW DEDICATION

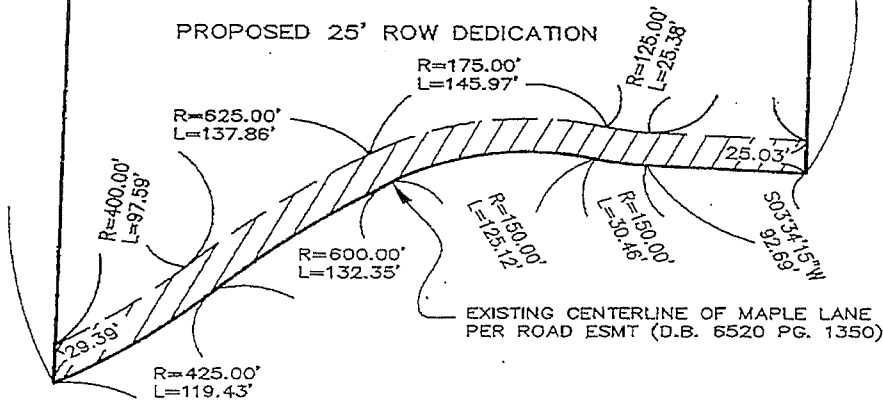

S05°34'15"W
92.69'

EXHIBIT "A"

INITIAL: *JS*

RIGHT-OF-WAY DEDICATION PLAT

A TRACT OF LAND BEING PART OF A LARGER TRACT OF LAND DESCRIBED IN A DEED TO VON DER AHE TRUCK AND TRAILER SERVICE, INC. RECORDED IN DEED BOOK 6742 PAGE 1582 OF THE ST. LOUIS COUNTY RECORDS AND BEING SITUATED IN THE NORTHWEST 1/4 OF SECTION 23, TOWNSHIP 44 NORTH, RANGE 5 EAST, CITY OF SUNSET HILLS, ST. LOUIS COUNTY, MISSOURI