

EXHIBIT 5

HISTORY OF DISCUSSION ON WHETHER THE STREETS WOULD BE PRIVATE OR PUBLIC; OTHER HISTORY

- The City has stated that it was always contemplated that the Manors' streets would be private. This is not accurate. There were earlier conversations about the streets in the Manors becoming public streets prior to the recording of the plats documented in the Minutes of the Planning and Zoning Commission dated October 4, 2000 and in the Minutes of the Board of Alderman meeting dated November 4, 2000.
- The Indenture referenced in the plats which was approved and signed by the City, vested the Trustees with the authority to have the streets dedicated as public.
- There was a discussion about having the VonderAhe family dedicate to the City (a portion of Maple Drive) to complete the traffic loop from Rott Road to Watson Road. The dedication(s) occurred in July, 2001. A copy of each of the dedications is attached as **Exhibit A**. Also attached as **Exhibit B** is a drawing showing the area dedicated to the City which is the west half of Maple Drive from the fairway crossing a hole 5 of the Tapawingo National Golf Course to approximately the private gate on Maple to the Moore property. This was part of the discussion about the streets.
- The Applicant began official discussions about having its streets accepted in 2015, and officially applied in 2017 with Tapawingo on the Greens and the owner of the Tapawingo National Golf Club. Its proposal was dropped after the Planning and Zoning Commission declined to recommend acceptance.

EXHIBIT 5-A

2
Notary

RIGHT OF WAY DEDICATION

MAYBELLE E. VON DER AHE being the owner(s) of a tract of land described in a deed recorded in Deed Book 12460 Page 1870 of the St. Louis County Records and being situated in the Northwest ¼ of Section 23, Township 44 North, Range 5 East, City of Sunset Hills, St. Louis County, Missouri, do hereby dedicate to the City of Sunset Hills the area shown as hachured  on the attached Plat, hereby made a part of this instrument.

Said Owner(s) for and in consideration of the sum of One Dollar and No/100 (\$1.00) and other valuable considerations paid by the **City of Sunset Hills**, the receipt of which is hereby acknowledged, do, by these presents, grant to the **City of Sunset Hills** the area as aforementioned for road purposes and public use forever.

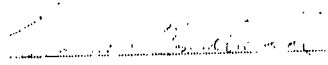
YVONNE VON DER AHE, Attorney-in-fact and
Trustee for Maybelle E. Von Der Ahe

COUNTY OF ST. LOUIS)
)SS.
STATE OF MISSOURI)

On this 11th day of April, 2000, before me personally appeared Yvonne Von Der Ahe ~~X~~ to me known to be the person(s) described in and who executed the foregoing instrument, and acknowledged that he/she/they executed the same as his/her/their free act and deed. ~~(*) ATTORNEY-IN-FACT AND TRUSTEE FOR MAYBELLE E. VON DER AHE~~

IN TESTIMONY WHEREOF, I have hereunto set my hand and affixed my official seal in the County and State aforesaid, the day and year first above written.

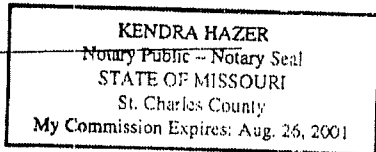

Notary Public

My term expires: _____



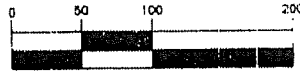

GRAPHIC SCALE



(IN FEET)
1 inch = 100 ft.

MERAMEC RIVER

N/F
THE MAYBELLE E. VON DER AHE
REVOCABLE LIVING TRUST
OF FEBRUARY 21, 1983
12460/1870

NEW ROW = 13,591 SQ. FT.

1032.±

N89°08'05"W

1032.9±

S89°08'05"E

PROPOSED 25' ROW DEDICATION

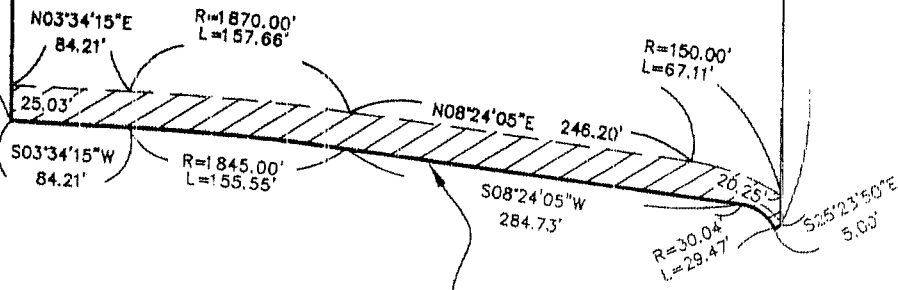

EXISTING CENTERLINE OF MAPLE LANE
PER ROAD ESMT (D.B. 6520 PG. 1350)

EXHIBIT "A"

INITIAL: _____

RIGHT-OF-WAY DEDICATION PLAT

A TRACT OF LAND BEING PART OF A LARGER TRACT OF LAND DESCRIBED IN A DEED TO THE MAYBELLE E. VON DER AHE REVOCABLE LIVING TRUST RECORDED IN DEED BOOK 12460 PAGE 1870 OF THE ST. LOUIS COUNTY RECORDS AND BEING SITUATED IN THE NORTHWEST 1/4 OF SECTION 23, TOWNSHIP 44

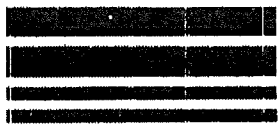

JANICE M. HAMMONDS, RECORDER OF DEEDS
ST. LOUIS COUNTY MISSOURI
41 SOUTH CENTRAL, CLAYTON, MO 63105

TYPE OF INSTRUMENT: **DIEDI** GRANTOR: **VON DER AHE TRUCK AND TRAILER SERV IN** TO: **CITY OF SUNSET HILLS** GRANTEE:

PROPERTY DESCRIPTION: **SEC 23 T 44 R 5**

Lien Number

Notation **X**

Locator

NOTE: I, the undersigned Recorder of Deeds, do hereby certify that the information shown on this Certification Sheet as to the TYPE OF INSTRUMENT, the NAMES of the GRANTOR and GRANTEE as well as the DESCRIPTION of the REAL PROPERTY affected is furnished merely as a convenience only, and in the case of any discrepancy of such information between this Certification Sheet and the attached Document, the ATTACHED DOCUMENT governs. The Recorder's official Grantor/Grantee indices are created from the information contained in the actual Document attached hereto. Only the DOCUMENT NUMBER, the DATE and TIME of filing for record and the BOOK and PAGE of the recorded Document is taken from this CERTIFICATION SHEET.

RECORDER OF DEEDS DOCUMENT CERTIFICATION

STATE OF MISSOURI)
SS.
COUNTY OF ST. LOUIS)

Document Number
909

I, the undersigned Recorder of Deeds for said County and State, do hereby certify that the following and annexed instrument of writing, which consists of 3 pages, (this page inclusive), was filed for record in my office on the 31 day of July 2001 at 11:08 AM and is truly recorded in the book and at the page shown at the top and/or bottom of this page.

In witness whereof I have hereunto set my hand and official seal the day, month and year aforesaid.

J. Ann Reber
Deputy Recorder

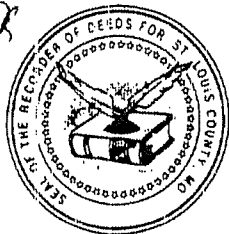

Janice M. Hammonds
Recorder of Deeds
St. Louis County, Missouri

- ___ N.P.
- ___ N.P.C
- ___ N.N.C.
- ___ N.N.I.

RECORDING FEE **\$26.00**
(Paid at the time of Recording)

Mail to:

[Empty rectangular box for mailing address]

Destination code: 3 P Do Not Remove This Page

B-13187 P-0250/0252

2
CLT 414458

BP13187.251

RIGHT OF WAY DEDICATION

Notation

VON DER AHE TRUCK AND TRAILER SERVICE, INC., being the owner(s) of a tract of land described in a deed recorded in Deed Book 6742 Page 1582 of the St. Louis County Records and being situated in the Northwest 1/4 of Section 23, Township 44 North, Range 5 East, City of Sunset Hills, St. Louis County, Missouri, do hereby convey to the **City of Sunset Hills**, the area shown as hachured [diagonal lines] on the attached Plat, hereby made a part of this instrument.

Said Owner(s) for and in consideration of the sum of One Dollar and No/100 (\$1.00) and other valuable considerations paid by the **City of Sunset Hills**, the receipt of which is hereby acknowledged, do, by these presents, grant to the **City of Sunset Hills** the area as aforementioned for road purposes and public use forever.

(Corporation)

[Signature]
YVONNE VON DER AHE, President, Von Der Ahe Truck & Trailer Service, Inc.

NO SEAL

Attest: *[Signature]*
[Signature]

COUNTY OF ST. LOUIS)
)SS.
STATE OF MISSOURI)

On this 10 day of July, 2000, before me appeared Yvonne Von Der Ahe personally known, who being by me duly sworn did say that he is President of Von Der Ahe Truck & Trailer Service, Inc. and that the seal affixed to the foregoing instrument is the corporate seal of said corporation, and that said instrument was signed and sealed in behalf of said corporation by authority of its Board of Directors, and said Yvonne Von Der Ahe acknowledged said instrument to be the free act and deed of said corporation

IN WITNESS WHEREOF, I have herewith set my hand and affixed my notarial seal the day and year first above written.

My term expires: July 26, 2001

[Signature]
Notary Public

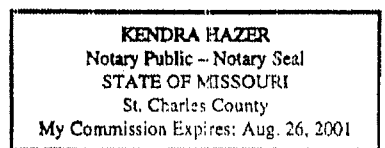



GRAPHIC SCALE

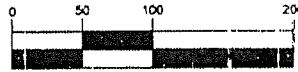

(IN FEET)
1 inch = 100 ft.

MERAMEC RIVER

N/F
VON DER AHE
TRUCK AND TRAILER
SERVICE, INC.
6742/1582

1285'±
N83°26'59"W

1032'±
S89°08'05"E

NEW ROW = 12,478 SQ. FT.

PROPOSED 25' ROW DEDICATION

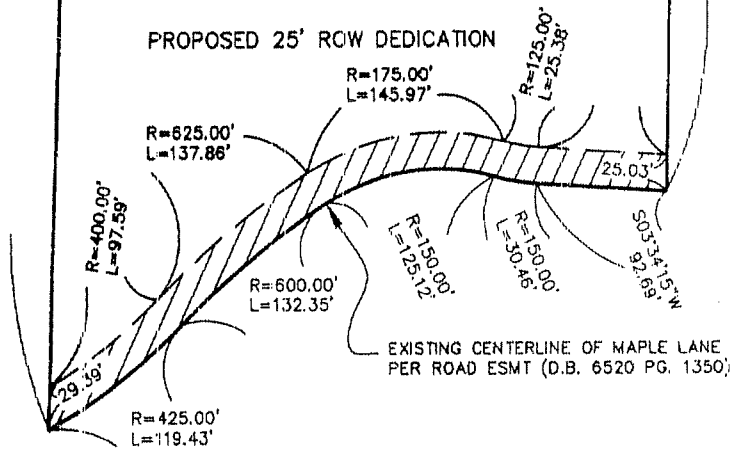

EXISTING CENTERLINE OF MAPLE LANE
PER ROAD ESMT (D.B. 6520 PG. 1350)

EXHIBIT "A"

INITIAL: . . .

RIGHT-OF-WAY DEDICATION PLAT

A TRACT OF LAND BEING PART OF A LARGER TRACT OF LAND DESCRIBED IN A DEED TO VON DER AHE TRUCK AND TRAILER SERVICE, INC. RECORDED IN DEED BOOK 6742 PAGE 1582 OF THE ST. LOUIS COUNTY RECORDS AND BEING SITUATED IN THE NORTHWEST 1/4 OF SECTION 23, TOWNSHIP 44 NORTH, RANGE 5 EAST, CITY OF SUNSET HILLS, ST. LOUIS COUNTY, MISSOURI



* 2001073100909 *

JANICE M. HAMMONDS, RECORDER OF DEEDS
ST. LOUIS COUNTY MISSOURI
41 SOUTH CENTRAL, CLAYTON, MO 63105

TYPE OF INSTRUMENT: DEDI
GRANTOR: VON DER AHE TRUCK AND TRAILER SERV IN
TO: CITY OF SUNSET HILLS
GRANTEE:

PROPERTY DESCRIPTION: SEC 23 T 44 R 5

Lien Number: [] Notation: X Locator: []

NOTE: I, the undersigned Recorder of Deeds, do hereby certify that the information shown on this Certification Sheet as to the TYPE OF INSTRUMENT, the NAMES of the GRANTOR and GRANTEE as well as the DESCRIPTION of the REAL PROPERTY affected is furnished merely as a convenience only, and in the case of any discrepancy of such information between this Certification Sheet and the attached Document, the ATTACHED DOCUMENT governs.

RECORDER OF DEEDS DOCUMENT CERTIFICATION

STATE OF MISSOURI)

Document Number

909

SS.

COUNTY OF ST. LOUIS)

I, the undersigned Recorder of Deeds for said County and State, do hereby certify that the following and annexed instrument of writing, which consists of 3 pages, (this page inclusive), was filed for record in my office on the 31 day of July 2001 at 11:08 AM and is truly recorded in the book and at the page shown at the top and/or bottom of this page.

In witness whereof I have hereunto set my hand and official seal the day, month and year aforesaid.

JoAnn Reber
Deputy Recorder

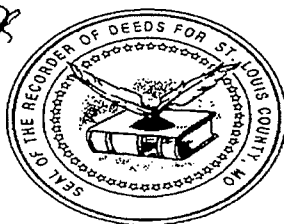

Janice M. Hammonds
Recorder of Deeds
St. Louis County, Missouri

- N.P.
- N.P.C.
- N.N.C.
- N.N.I.

RECORDING FEE \$26.00
(Paid at the time of Recording)

Mail to:

[Empty box for mail destination]

Destination code: 3

P

Do Not Remove This Page

B-13187 F-0250/0252

CTI 414458
2

Notation

RIGHT OF WAY DEDICATION

VON DER AHE TRUCK AND TRAILER SERVICE, INC. being the owner(s) of a tract of land described in a deed recorded in Deed Book 6742 Page 1582 of the St. Louis County Records and being situated in the Northwest 1/4 of Section 23, Township 44 North, Range 5 East, City of Sunset Hills, St. Louis County, Missouri, do hereby convey to the **City of Sunset Hills**, the area shown as hachured  on the attached Plat, hereby made a part of this instrument.

Said Owner(s) for and in consideration of the sum of One Dollar and No/100 (\$1.00) and other valuable considerations paid by the **City of Sunset Hills**, the receipt of which is hereby acknowledged, do, by these presents, grant to the **City of Sunset Hills** the area as aforementioned for road purposes and public use forever.

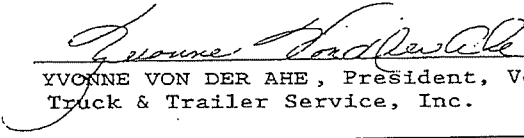
(Corporation)
NO SEAL

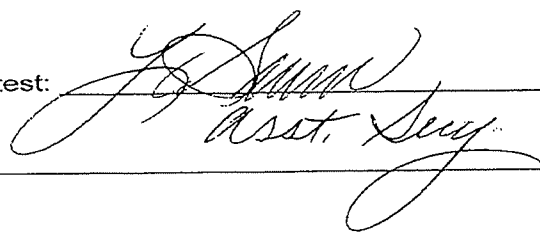
YVONNE VON DER AHE, President, Von Der Ahe Truck & Trailer Service, Inc.

Attest: 
Asst. Secy

COUNTY OF ST. LOUIS)
)SS.
STATE OF MISSOURI)

On this 4th day of April, 2001, before me appeared Yvonne Von Der Ahe personally known, who being by me duly sworn did say that he is President of Trailer Service, Inc. and that ~~the seal affixed to the foregoing instrument is the corporate seal of said corporation~~, and that said instrument was signed and sealed in behalf of said corporation by authority of it Board of Directors, and said Yvonne Von Der Ahe acknowledged said instrument to be the free act and deed of said corporation

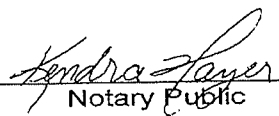
IN WITNESS WHEREOF, I have herewith set my hand and affixed my notarial seal the day and year first above written.
My term expires: Aug. 26, 2001

Kendra Hazer
Notary Public

KENDRA HAZER
Notary Public - Notary Seal
STATE OF MISSOURI
St. Charles County
My Commission Expires: Aug. 26, 2001



GRAPHIC SCALE

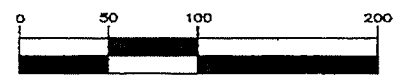

(IN FEET)
1 inch = 100 ft.

MERAMEC RIVER

N/F
VON DER AHE
TRUCK AND TRAILER
SERVICE, INC.
6742/1582

1285'±

1032'±

N88°26'59"W

S89°08'05"E

NEW ROW = 12,478 SQ. FT.

PROPOSED 25' ROW DEDICATION

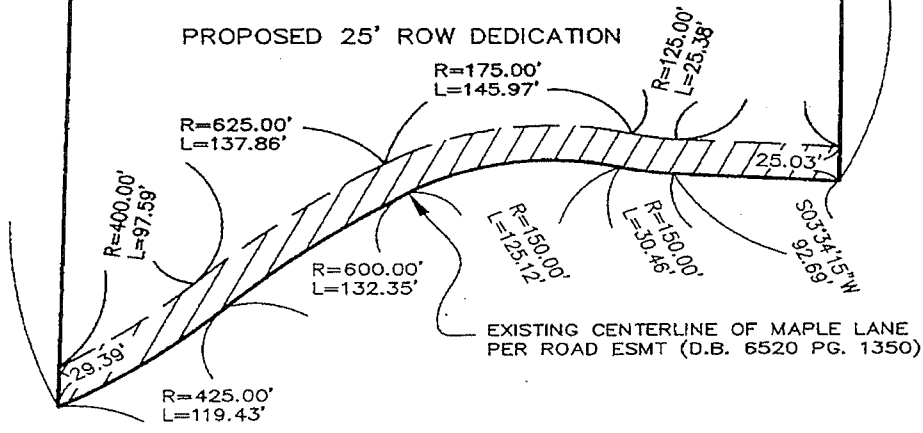

EXISTING CENTERLINE OF MAPLE LANE
PER ROAD ESMT (D.B. 6520 PG. 1350)

EXHIBIT "A"

INITIAL: *dy*

RIGHT-OF-WAY DEDICATION PLAT

A TRACT OF LAND BEING PART OF A LARGER TRACT OF LAND DESCRIBED IN A DEED TO VON DER AHE TRUCK AND TRAILER SERVICE, INC. RECORDED IN DEED BOOK 6742 PAGE 1582 OF THE ST. LOUIS COUNTY RECORDS AND BEING SITUATED IN THE NORTHWEST 1/4 OF SECTION 23, TOWNSHIP 44 NORTH, RANGE 5 EAST, CITY OF SUNSET HILLS, ST. LOUIS COUNTY, MISSOURI

EXHIBIT 5-B

